



특징 (Character)

- TAPER ROLLER WAY & ROLLER를 이용한 구동방식
Roller way & Roller type
- 고정도, 고강성 구조로 안정된 파지력
High precision & strength structure
- 박형 BODY의 3방향 취부가능
Easy to 3-directions(compact body)
- 개폐검출 센서 전기종 부착가능
Magnetic sensor is available for open-close sensing



AF101
AF02
AF03
AF04P
AF105P
AF06
AF10
AF13
AF13C
AF14
AF15
AF316
AF17
AF117
AF19
AF24
AF26
AF28D
AF30
AF30L
AF30SP
AF40
AF46
AF56N
RAF56N
MF16

롤러 & 테이퍼 롤러가이드 방식 (Taper roller way & Roller type)

작동 방식 (Kinetics)

정교한 파지를 위한 유격이 작은
롤러 가이드 방식
roller guide type precise
gripping

구동부 (Drive)

복동식
double acting
pneumatic cylinder

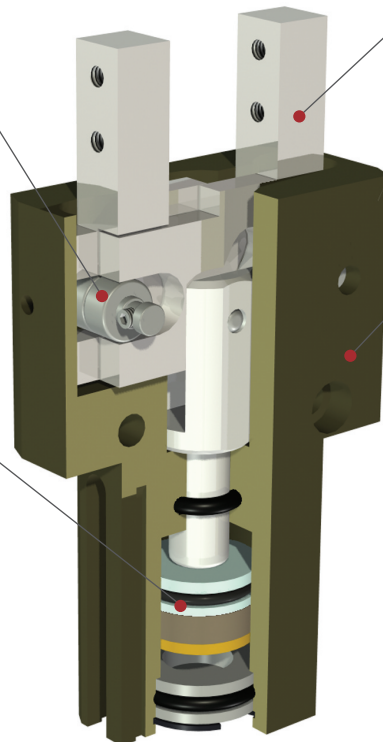

조 (Jaws)

파지부
for gripping

몸체 (Body)

경질 처리된 경량의
알루미늄 합금
high-tensile aluminum body with
lightest possible because of
hard anodizing

부품분해도 (Exploded view)

※ 본 분해도는 한 제품을 예시하였으므로 기종별로 차이가 있을 수 있습니다
 ※ This exploded view illustrates a certain product only. The contents may vary by product models.

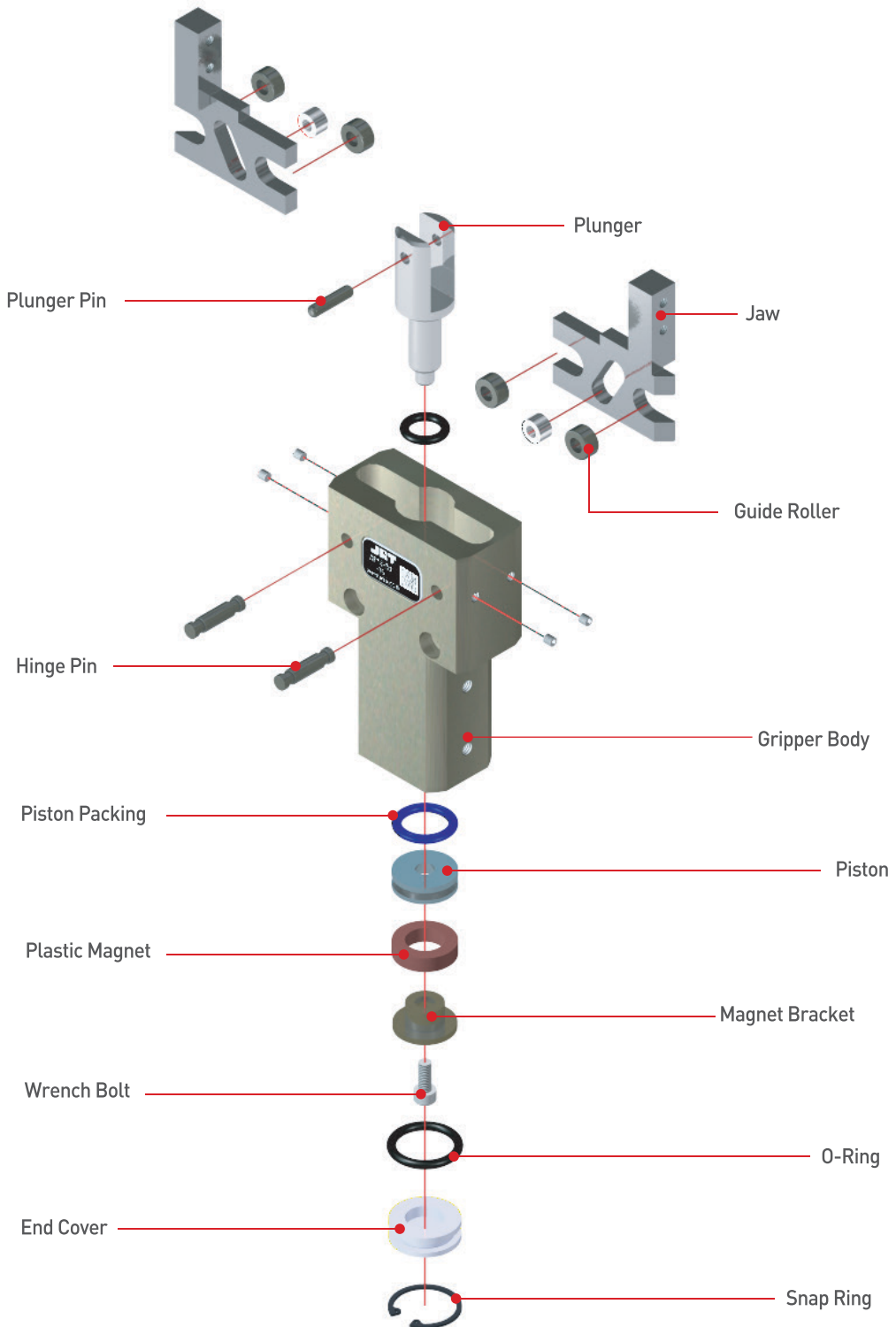

주문기호 (Ordering Code)

- AF101
- AF02
- AF03
- AF04P
- AF105P
- AF06
- AF10
- AF13
- AF13C
- AF14**
- AF15
- AF316
- AF17
- AF117
- AF19
- AF24
- AF26
- AF28D
- AF30
- AF30L
- AF30SP
- AF40
- AF46
- AF56N
- RAF56N
- MF16

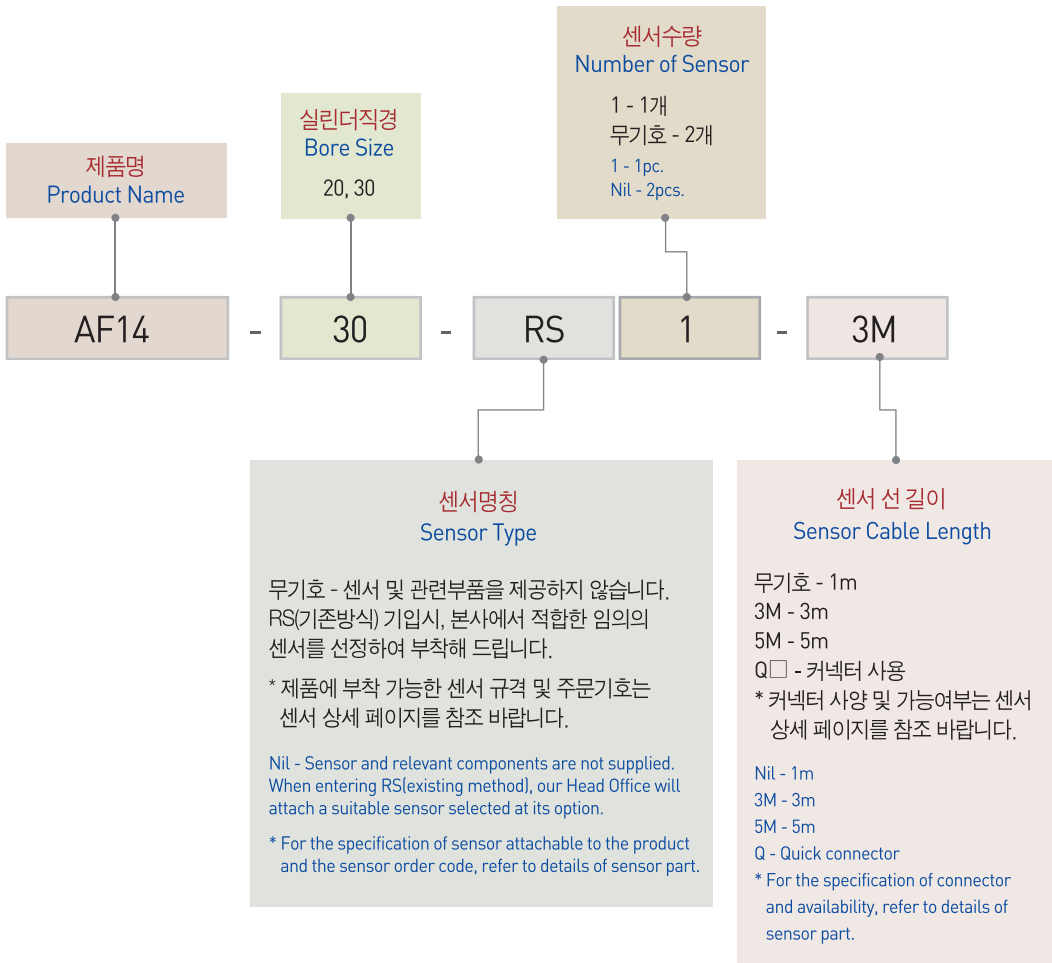

☐ 제품사양 (Specification)

P=공기압력(bar) , L=작용점까지의 거리(mm)
P=Air Pressure(bar) , L=Exertion length(mm)

제품명칭 Products Name	AF14-20	AF14-30	단위 Unit
개폐범위 Stroke	10	12	mm
제품중량 Weight	0.38	0.72	kg
최대치구길이 Max. length attach	70	80	mm
배관접속구 Fitting size	M5	PF(G) 1/8	
파지력 : 열림시 Gripping force : Open	24.53(P-0.003L)	44.15(P-0.002L)	N
파지력 : 닫힘시 Gripping force : Close	35.32(P-0.002L)	60.82(P-0.002L)	N
1사이클당 공기소모량 Air consumption per cycle	5.5	14.6	cm ³
닫힘시/열림시 시간 Closing / Opening time	0.01/0.01	0.01/0.01	sec
반복정밀도 Repeat accuracy	0.03	0.03	mm
연속사용회수 Continuation usage amount	60	40	cpm
사용압력 Operating pressure	3~7		bar
주위온도 Ambient temperature	-5 to 60		℃
윤활 Lubrication	불필요 Needless		

반복정밀도 : 연속 100회 작동후 측정치
After 100 consecutive strokes to end positions

☐ 작용점에서의 파지력 (Gripping Force From a Point of Action)

범례 (Legend) : —■ 7[bar] —■ 5[bar] —■ 3[bar]

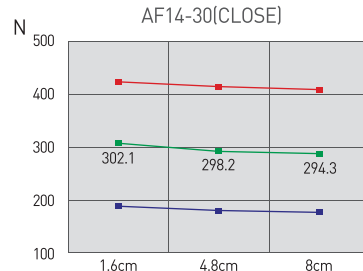
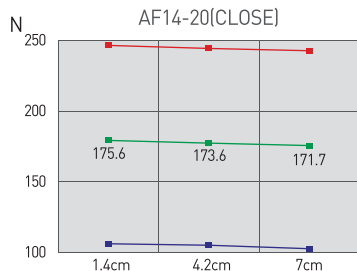
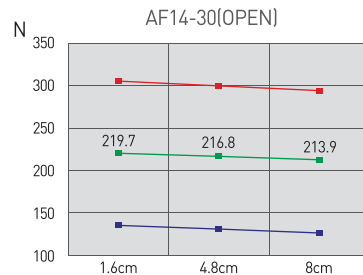
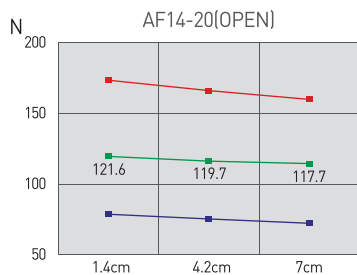

AF14-20

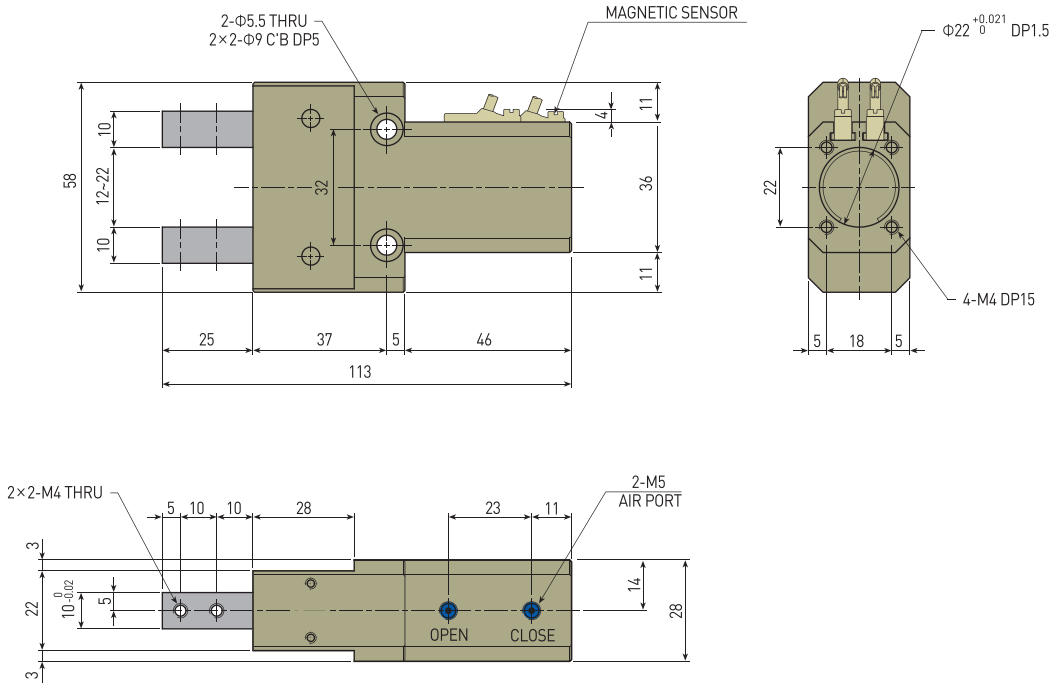

AF14-30

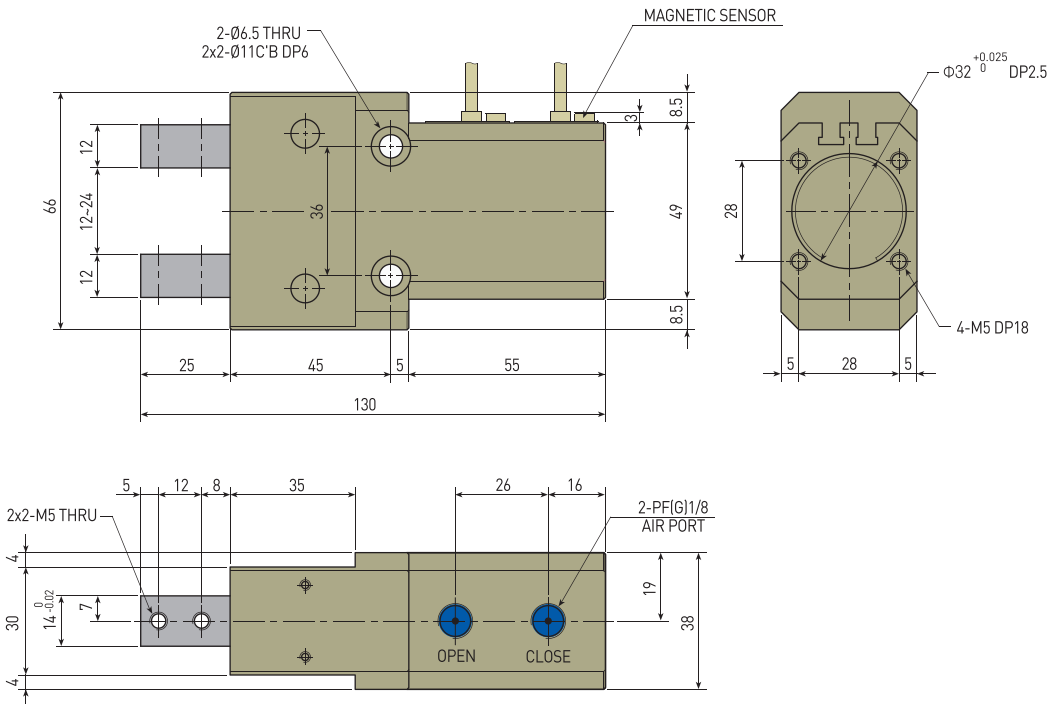

- AF101
- AF02
- AF03
- AF04P
- AF105P
- AF06
- AF10
- AF13
- AF13C
- AF14**
- AF15
- AF316
- AF17
- AF117
- AF19
- AF24
- AF26
- AF28D
- AF30
- AF30L
- AF30SP
- AF40
- AF46
- AF56N
- RAF56N
- MF16